

THE INFORMATION CONTAINED IN THIS DRAWING IS THE SOLE PROPERTY OF PROMATS, INC. AND ANY REPRODUCTION IN PART OR WHOLE WITHOUT THE WRITTEN PERMISSION OF PROMATS, IS PROHIBITED.

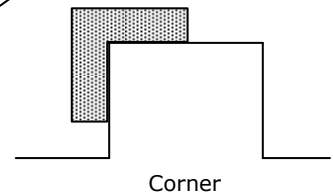

Royal Blue	Gold	Purple	Navy Blue	White	Kelly Green	Sky Blue
Red	Forest Green	Burgundy	Grey	Black	Orange	Camel

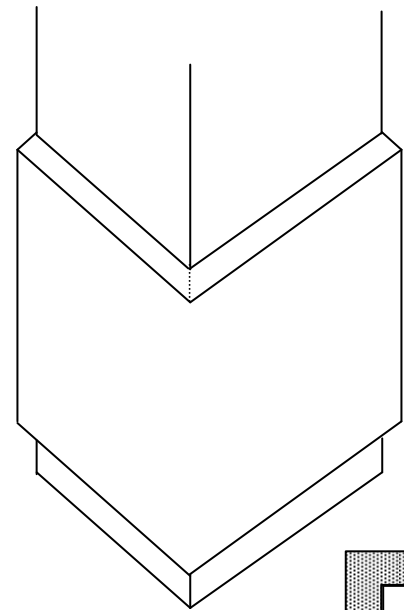
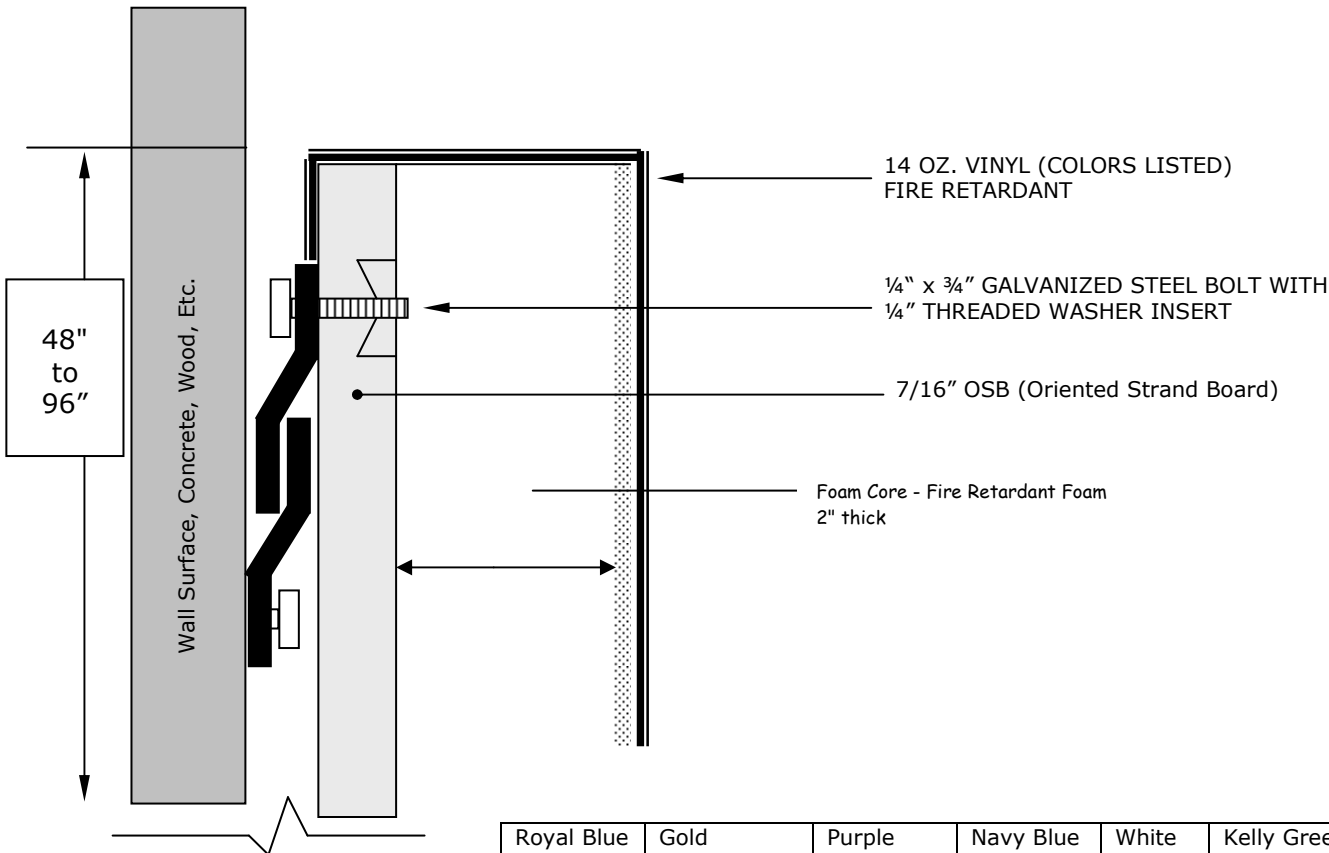
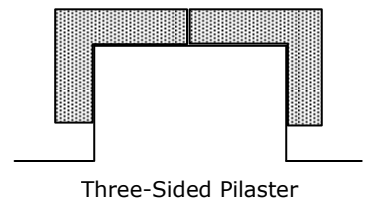

**Wall Padding Specifications:
Wood Backed Pads for Interior Use
Column Pad (CPZTBFR)**

Vinyl Cover: 14 oz. Vinyl, Leather Grain appearance. Vinyl. 1300 Denier Polyester Base Fabric.
Tear Strength 93 x 83 Strip Tensile 365 x 348
Anti-fungal, Flame Resistant: Meets ASTM E84
Cover is wrapped around the backside of the plywood and is stapled every 3" with galvanized steel staples.

Plywood: 7/16" Oriented Strand Board

Attachment: One Pair of 18 ga. Galvanized metal "Z" Clips are used to mount the pads to the wall. "Z" Clips are mounted by 1/4" bolts screwed into threaded washer inserts. The wall "Z" Clips are fastened with an appropriate anchor (provided by installer) for each wall type. Z Clip on top and bottom standard.

Foam Core: Glued to the OSB backing NEOPRENE
2" Polychloroprene Latex Compound 45-65 ILD "firm"

April 5, 2007

Interior Wall Pad
Wood Backed Column Pad
(CPZTBFR)

NOT TO SCALE



Post Office Box 508
Fort Collins, CO 80522-0508
800-678-6287
FAX 970-482-7740

Drawn By: _____
Drawing #: _____
Project Name: _____