

THE INFORMATION CONTAINED IN THIS DRAWING IS THE SOLE PROPERTY OF PROMATS, INC. AND ANY REPRODUCTION IN PART OR WHOLE WITHOUT THE WRITTEN PERMISSION OF PROMATS,

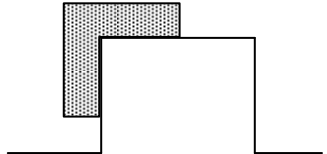

Corner

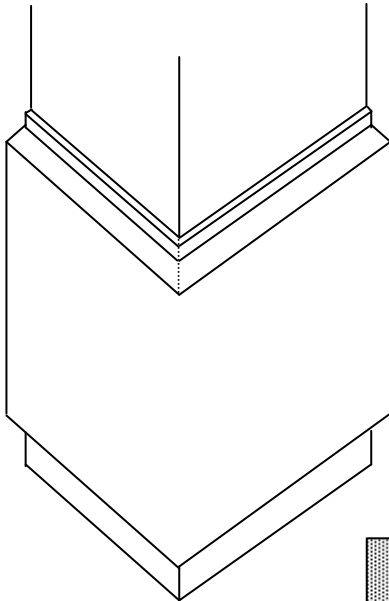
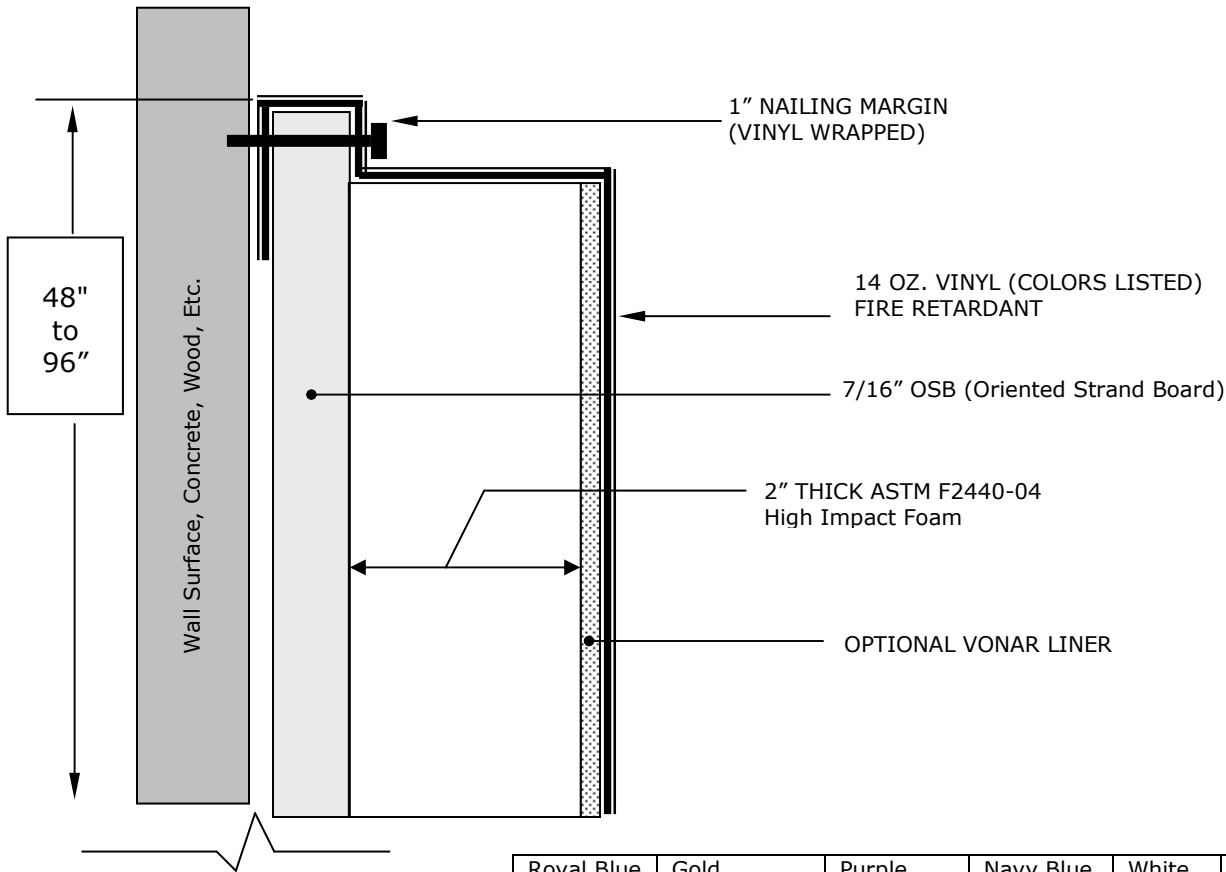
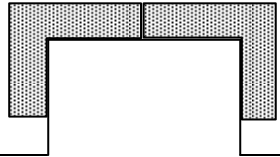

Three-Sided Pilaster

Royal Blue	Gold	Purple	Navy Blue	White	Kelly Green	Sky Blue
Red	Forest Green	Burgundy	Grey	Black	Orange	Camel

**Wall Padding Specifications:
Wood Backed Pads for Interior Use
Column Pad (CPHI)**

Application: Masonry or Wood Walls
Backing: 7/16" OSB (Oriented Strand Board)
Vinyl Covering: 14 oz. Vinyl, Leather Grain appearance, 1300 Denier Polyester Base Fabric, Tear Strength: 93 x 83, Strip Tensile: 365 x 348, Anti-fungal, Flame Resistant: Class A. Colors per manufacturer's standard selection, as selected by Architect. Vinyl cover is wrapped around the backside of the wood and stapled every 3" with galvanized steel staples.
Filler Foam for wood backed pads: 2" THICK ASTM F2440-04 High Impact Foam
Attachment: 1" Nailing Margin at top and bottom of pad.

April 3, 2007
 Interior Wall Pad
 Wood Backed Column Pad
 (CPHI)
 NOT TO SCALE



Post Office Box 508
 Fort Collins, CO 80522-0508
 800-678-6287
 FAX 970-482-7740

Drawn By:
 Drawing #:

Project Name: